

“HOW WILL WE LIVE TOGETHER?”

A Plateau for Coexistence aims to think to public and open space not only as a non-built surface, but as a proper infrastructure. The main focus is on the coexistence of multiple uses and layers in the same area: city functions, connections of fluxes, social activities are seen not as detrimental, but as a source of possibilities for plant and animal life, returning in the project site after a long industrial past. A system of public spaces comes together with a series of different biotopes - the meadow, the wooded low forest, the wetland - and changes with them. Following the opening of occupied lots, both city and nature will take again possess of Mälarporten.

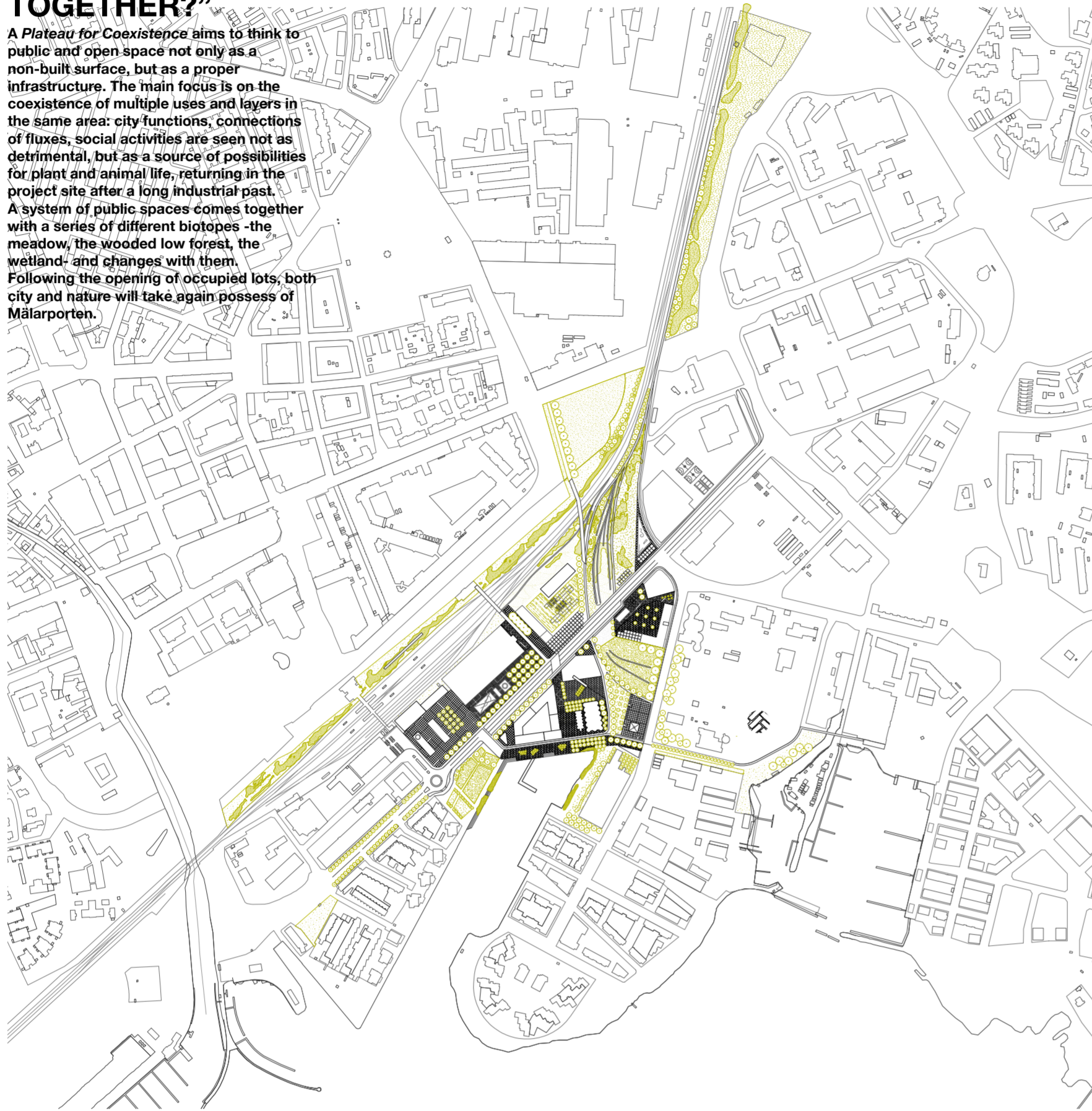

FLUXES AND CONNECTIONS

as an infrastructure, plateau acts as a connector with the city center to attract new fluxes in Mälarporten.

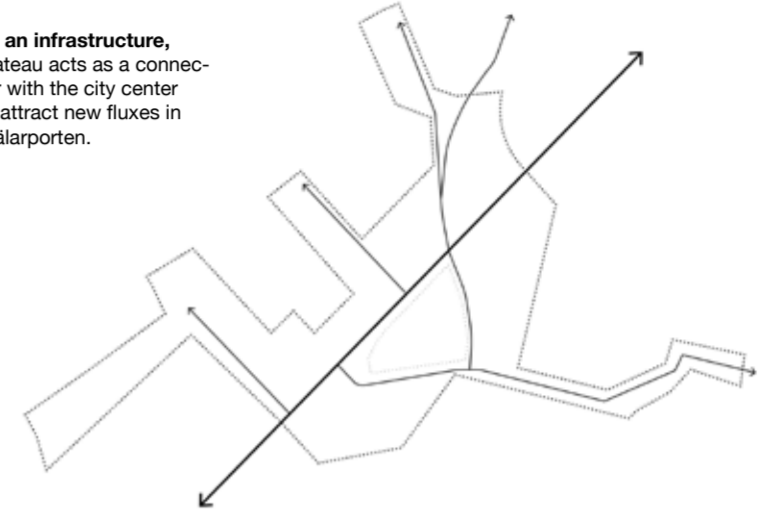

PERMEABILITIES

as a ground-based action, plateau reclaims the land by using phytoremediation system and drainage material



PUBLIC SPACE AS A BIOME MATRIX

as a generator, plateau finds its reasons by defining public space to make the area attractive.

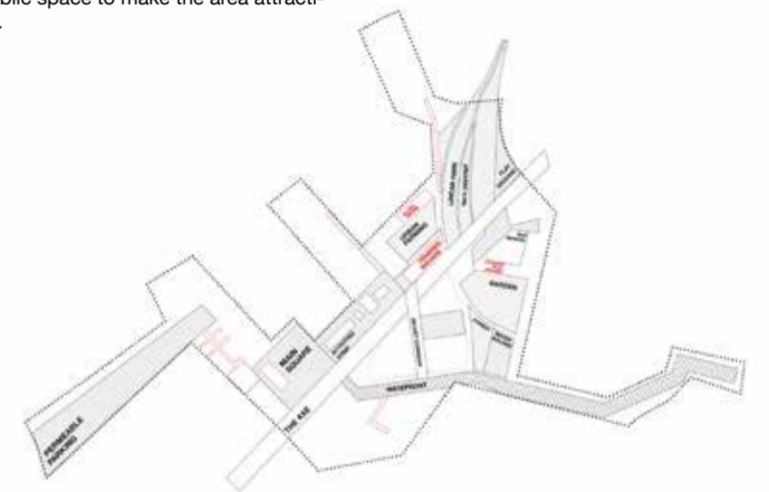

ELEMENTS

BIOMES

EVOLUTION

PHASE 1

Envisioned between today and the year 2024. The first phase envisioned a gradual soil reclamation by using specific plants and nature as a technology to regenerate the ground. It is mainly a ground action, which leads to the creation of the main connector street and different types of new public spaces. The main architectural interventions bring the creations of small structures, such as bridges, pergolas

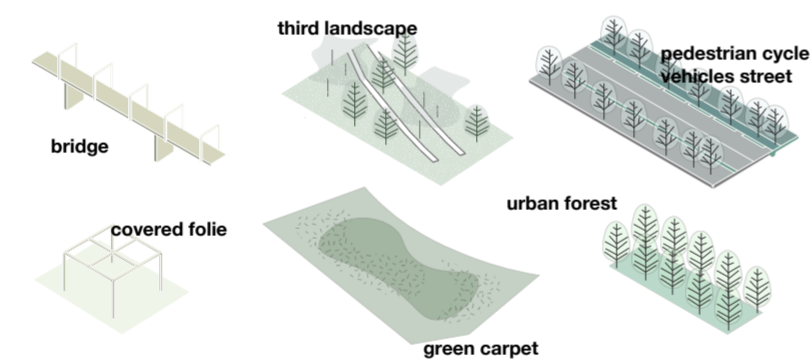

PHASE 2

Envisioned between 2024-2030. The second phase moves to large and solid intervention. With the new regenerated soil, the project invades the area by regenerating some existing structures and building new elements, such as cultural forum and office and laboratories, to gradually bring new people in the area.

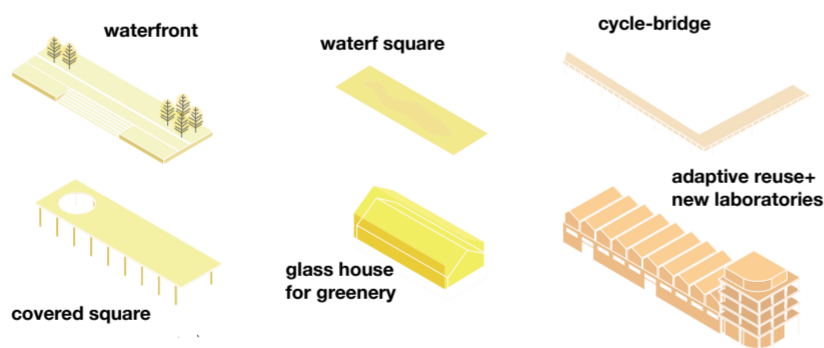

PHASE 3

Envisioned between 2030-2035. The last, but not least, phase is open to new development. the unavailable paved area, totally regenerated, are ready to be built and host new permanent function, such as residence and offices. This last phase is a part of an ongoing process, and still gives space to new possibilities.

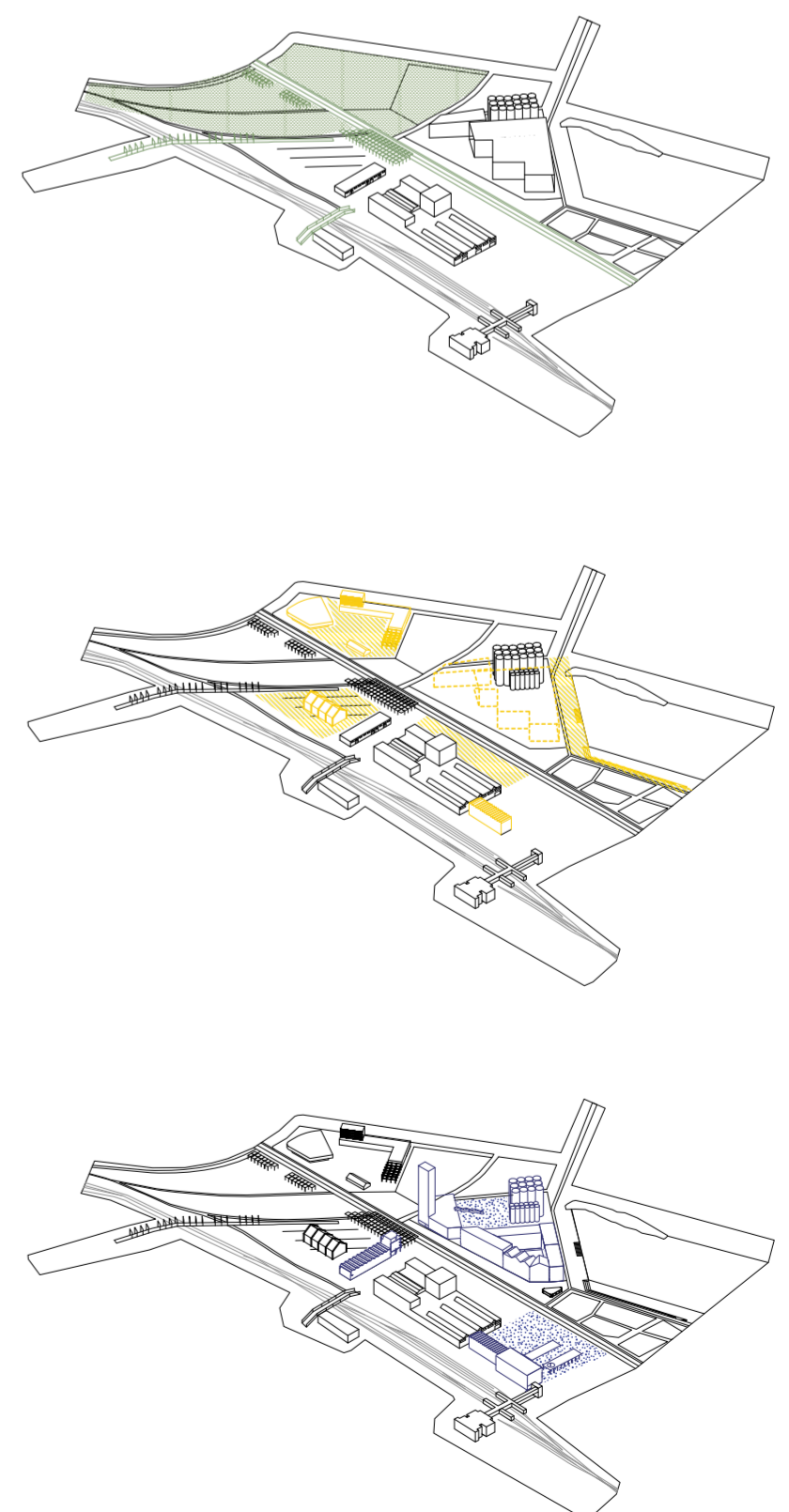
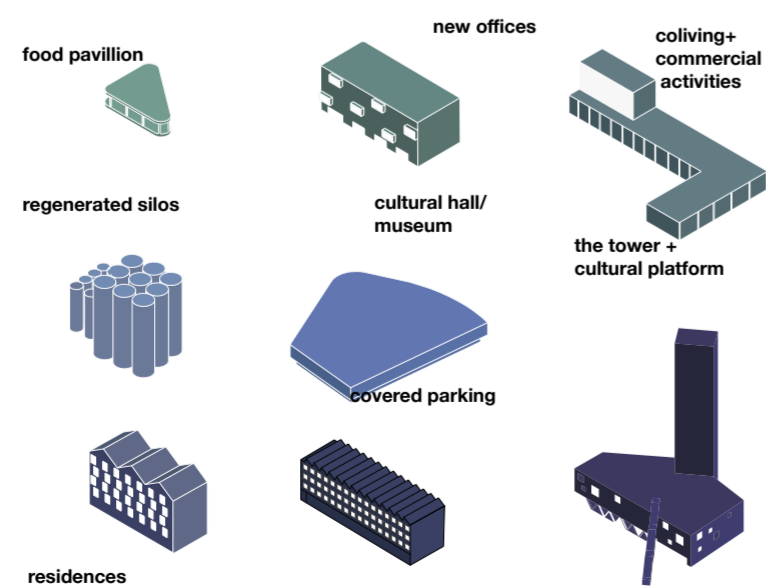

KN371

2035...

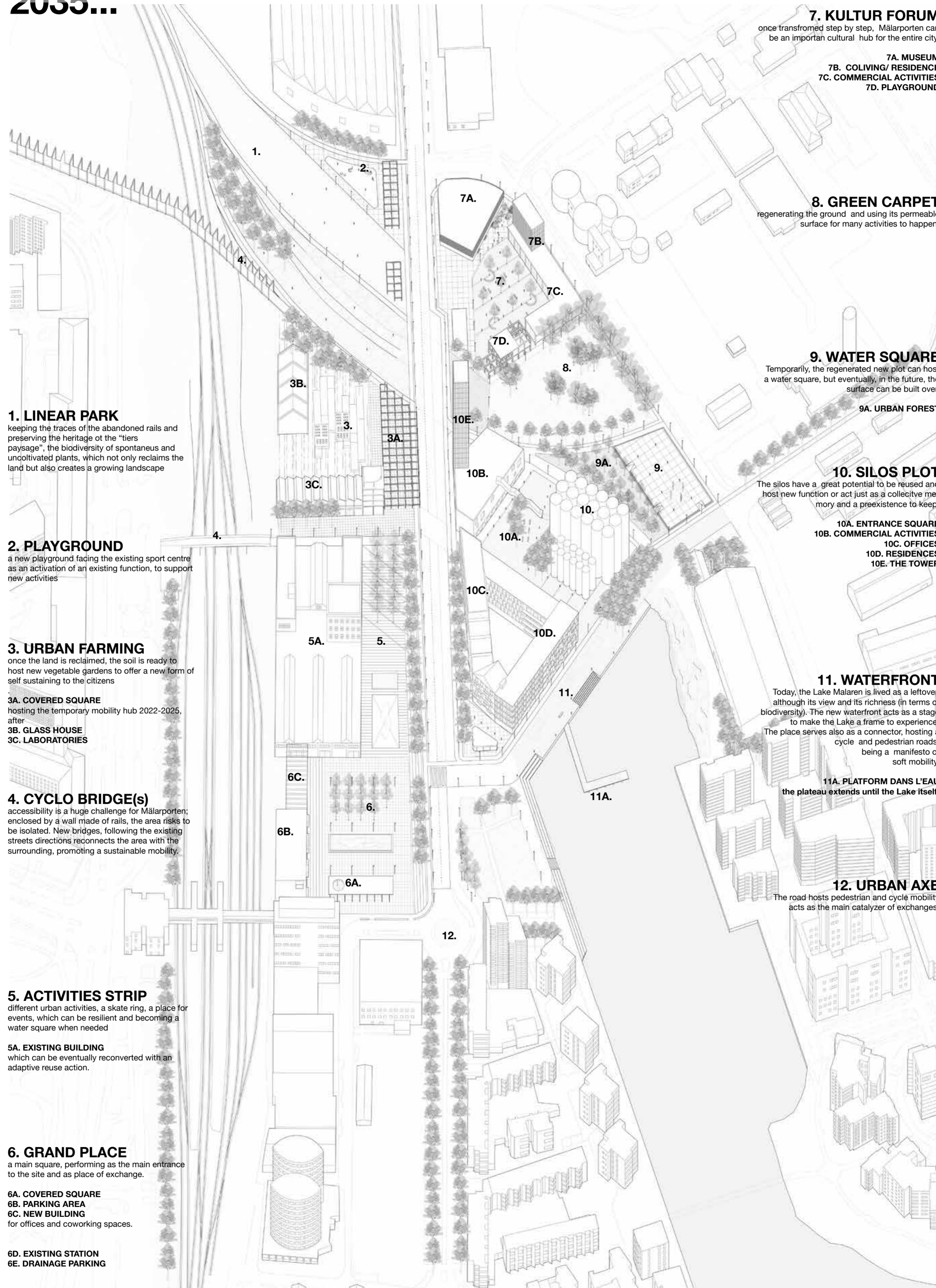

**1. LINEAR PARK**

keeping the traces of the abandoned rails and preserving the heritage of the "tiers paysage", the biodiversity of spontaneous and uncultivated plants, which not only reclaims the land but also creates a growing landscape

**2. PLAYGROUND**

a new playground facing the existing sport centre as an activation of an existing function, to support new activities

**3. URBAN FARMING**

once the land is reclaimed, the soil is ready to host new vegetable gardens to offer a new form of self sustaining to the citizens

**3A. COVERED SQUARE**

hosting the temporary mobility hub 2022-2025, after

**3B. GLASS HOUSE**

**3C. LABORATORIES**

**4. CYCLO BRIDGE(S)**

accessibility is a huge challenge for Mälarpöten; enclosed by a wall made of rails, the area risks to be isolated. New bridges, following the existing streets directions reconnects the area with the surrounding, promoting a sustainable mobility.

**5. ACTIVITIES STRIP**

different urban activities, a skate ring, a place for events, which can be resilient and becoming a water square when needed

**5A. EXISTING BUILDING**

which can be eventually reconverted with an adaptive reuse action.

**6. GRAND PLACE**

a main square, performing as the main entrance to the site and as place of exchange.

**6A. COVERED SQUARE**

**6B. PARKING AREA**

**6C. NEW BUILDING**  
for offices and coworking spaces.

**6D. EXISTING STATION**

**6E. DRAINAGE PARKING**

**7. KULTUR FORUM**  
once transformed step by step, Mälarpöten can be an important cultural hub for the entire city.

- 7A. MUSEUM
- 7B. COLIVING/ RESIDENCE
- 7C. COMMERCIAL ACTIVITIES
- 7D. PLAYGROUND

**8. GREEN CARPET**  
regenerating the ground and using its permeable surface for many activities to happen.

**9. WATER SQUARE**  
Temporarily, the regenerated new plot can host a water square, but eventually, in the future, the surface can be built over.

**9A. URBAN FOREST**

**10. SILOS PLOT**  
The silos have a great potential to be reused and host new function or act just as a collective memory and a preexistence to keep.

- 10A. ENTRANCE SQUARE
- 10B. COMMERCIAL ACTIVITIES
- 10C. OFFICES
- 10D. RESIDENCES
- 10E. THE TOWER

**11. WATERFRONT**  
Today, the Lake Malaren is lived as a leftover, although its view and its richness (in terms of biodiversity). The new waterfront acts as a stage to make the Lake a frame to experience. The place serves also as a connector, hosting a cycle and pedestrian roads, being a manifesto of soft mobility.

**11A. PLATFORM DANS L'EAU**  
the plateau extends until the Lake itself.

**12. URBAN AXE**  
The road hosts pedestrian and cycle mobility acts as the main catalyzer of exchanges.

1. LINEAR PARK

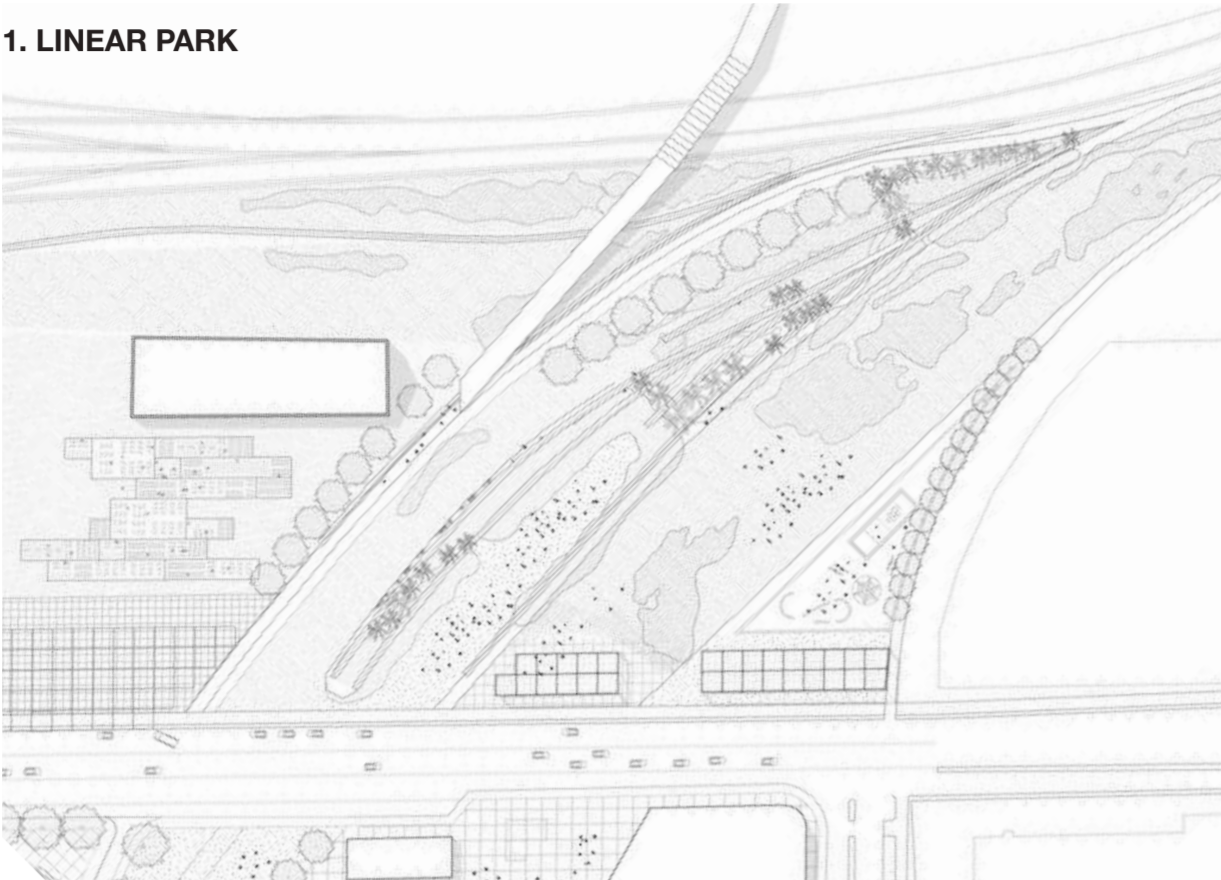

8. GREEN CARPET

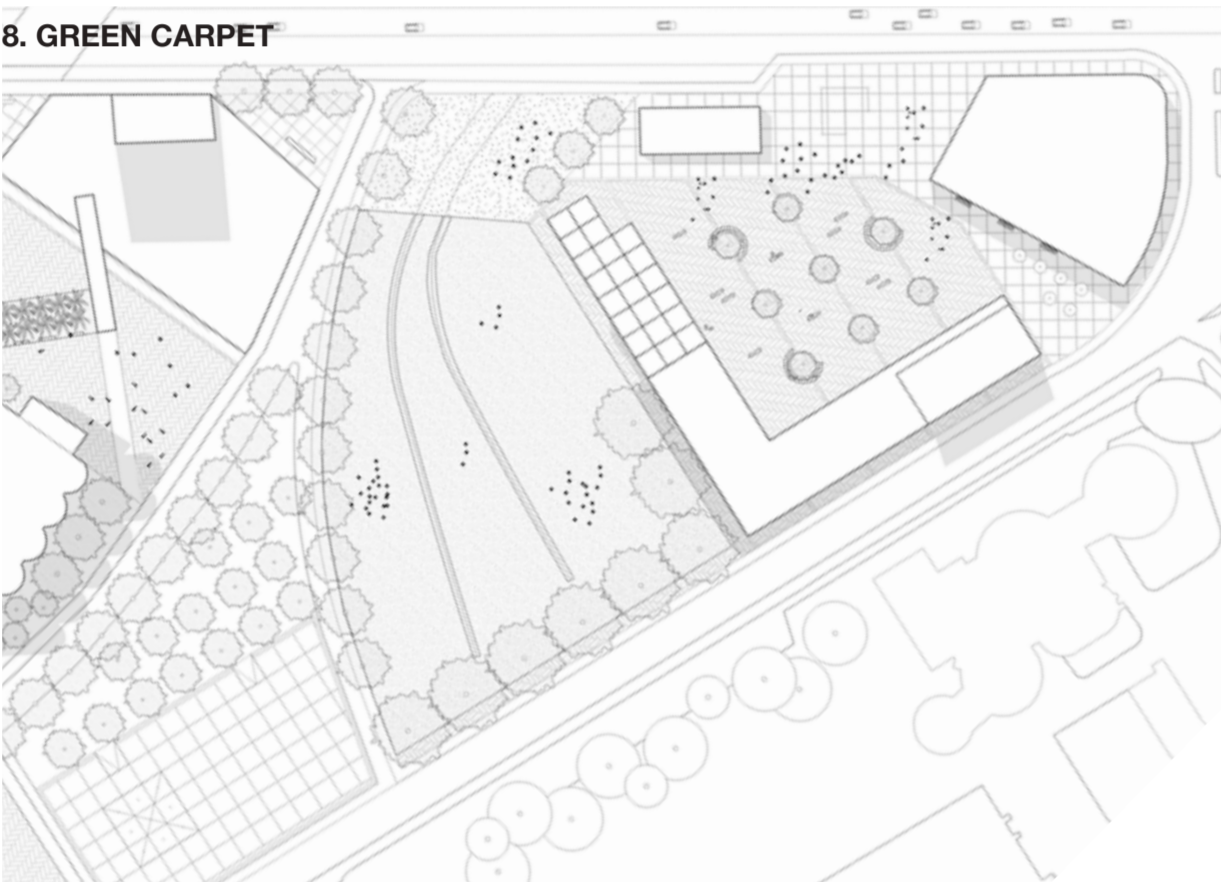

6. GRAND PLACE

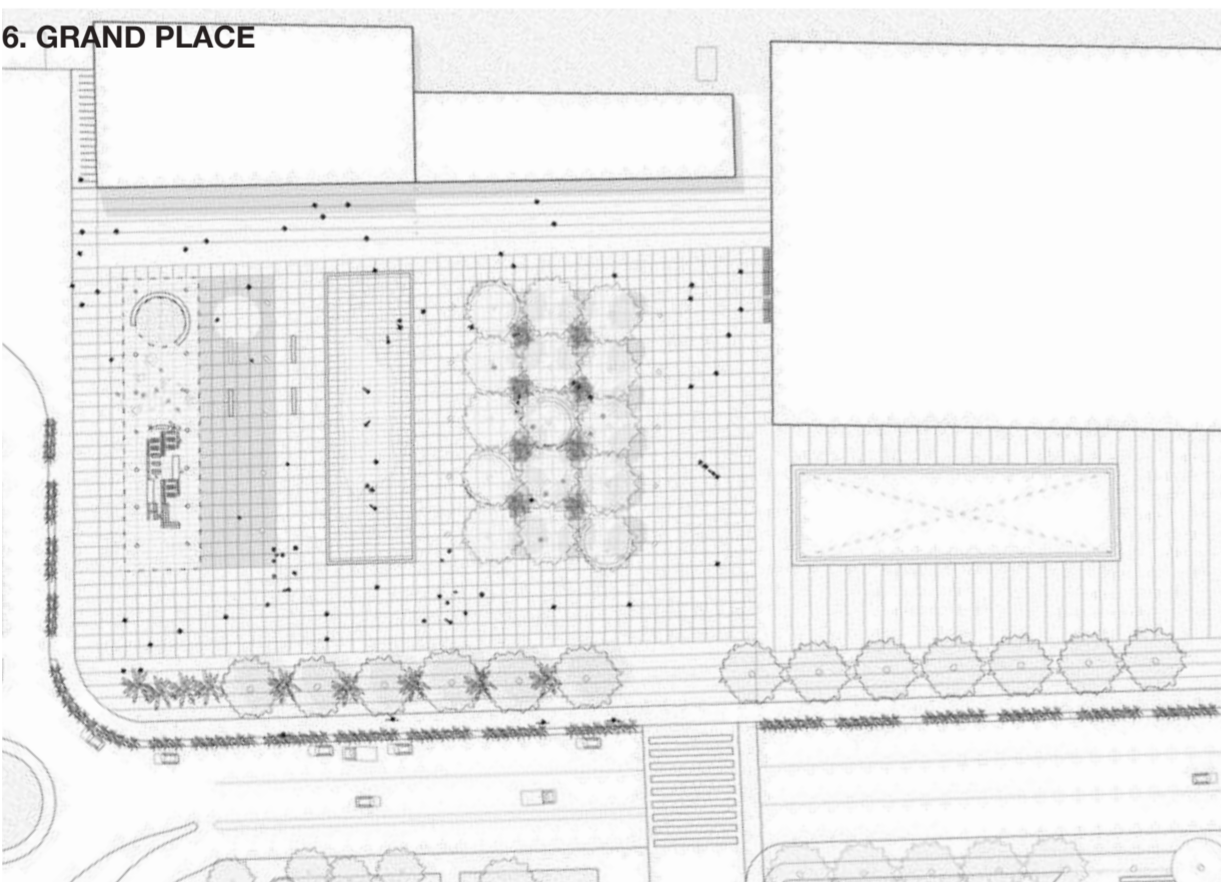

11. WATERFRONT

