



Västerås is an old town with a long history as a hub for productivity and commerce, both as an agricultural as well as an industrial city. One of the most prominent productions was the steel industry and the location by the water made it a natural settlement area. Large parts of the industry have since then moved to other places and given space for a new type of city built with closeness to the capital and with a new economy in mind. Furthermore, the study area, which used to be a meadow is now transformed through industrialisation. Climate change, loss in biodiversity, the post-pandemic social landscape, and our new non-physical social life all together poses new challenges that needs new solutions and strategies. By reconnecting social life through public spaces and self-sustainability by involvement in local places are proposed as ways to encourage and strengthened future life. New development by the water and the new train station naturally makes the area go through changes, turning it from a previous industrial and marine area to an urban area close to the

centre. By proposing a new strategy for reinforcing local life and engagement, a sense of place is created through new activities and soft spaces such as parks and structures, combining the urban with the rural life. The proposal introduces a circular way of thinking, partly by recreating some of the previous biological and natural systems and by promoting, educating on circular economies and circular building systems. New structures are designed as modular and can be altered or moved when needed. They are to be used during the changes the area are going through while building the new central train station. These modular and flexible structures easily be disassembled and placed on different locations when the new station is implemented, and they are replaced by new development. The modular system can encourage participation by involving citizens in the relocation as a cooperative process; placement, use and assembly disassembly can all me made into democratic processes.

While construction of the new station is under way, information regarding production and circular economy is spread to the inhabitants through circular information hubs which help shows ways to a new possible future. Urban farming, Sustainability Hubs, Makerspace, and public spaces with activity for all ages are proposed. The area goes from empty to populated and a lively street environment is enhanced through pedestrian infrastructure, activity and spaces for reuse/repairation/recycling and biodiversity. This proposal aims to connect the past with the present and the future, the global with the local, biological with the man made, the local with the global, the old with the new, the permanent with the temporary and the social with the solitary. Furthermore, it connects physical spaces through parks and interventions in the landscape that enhances the urban fabric.

Structures are implemented to support local economic, ecologic, social and cultural life. Sharing spaces and

supportive systems with built in solutions for reuse, food production and eco systems. The proposed shared housing systems, which combines youth homes and/or student housing together with hotel rooms helps establishes the area as a place for a new way of living. A sustainable lifestyle is encouraged by promoting walking and bicycling and traveling by train. On the roof there is generous space for farming for the tenants. This part can be covered or left open like an allotment association. The outdoor baths provide activity in the summertime and give the area a fun and inspiring way of life. If the water quality is poor, pools with plants that can purify water will provide fresh water. The shallow kids pool is used by children in summertime and when water is drained it instead becomes a place for outdoor skateboarding. The new canal is made with green edges and ties together with the boat area which in turn further provide water cleaning properties as well as recover some of the wet land qualities that has been lost with the hardening of the surfaces around the water edge

preventing flooding during heavy rain. In addition to this, it provides safe spots for wildlife to establish in this specific habitat.

Using materials such as wood, steel and glass or polycarbonate which are suitable for reuse or repurpose. A steel structured roof by the temporary train station connects to Västerås history of steel production and with the new roof structure that is planned. Modular dimensions are preferred to make them easy to reuse.

Parts of the area are claimed as park and for meadows that provide soft green surfaces, thus creating a green structure and reinforcing biodiversity. This also establishes green public areas for future development with focus on sustainability. The proposal retrieves some of the productive history of Västerås by introducing food production and repairing/upscaling and reuse.

The strategies are connected though space and activity. The proposal suggests that all of the new structures and programmes should contain various levels of activity, productivity and reinforce biodiversity.



ACTIVITY

Local involvement through activities for different ages and interests. Activity, making spaces flexible that encourages different uses people with establish a sense of place through participation in public spaces as well as connectivity by infrastructure. It will give a sense of ownership in ones city.



PRODUCTIVITY

Different kinds of productivity focused on circular systems, reuse, upscaling, shared use, repairation and urban farming and water farming (mussels and algae). Another effect of farming is purification of the soil and water.



BIODIVERSITY

Components that are targeted to enforce local species and pollinators. Parks with free growing meadows that creates favorable conditions for insects and birds.



Elevation 1:500

HR767 VÄSTERÅS (SE) A (B) RIDGE BY THE WATER

2



Plan 1:2000

Structures

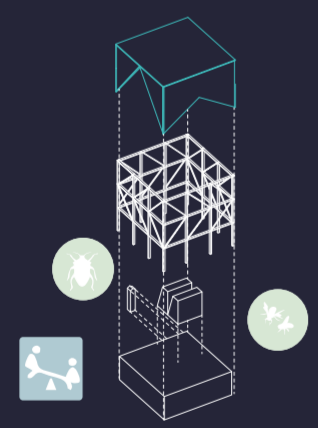

Workshop/info/circular hub/tools/repairs
Wooden structure in modular dimensions
Components of biological diversity attachments

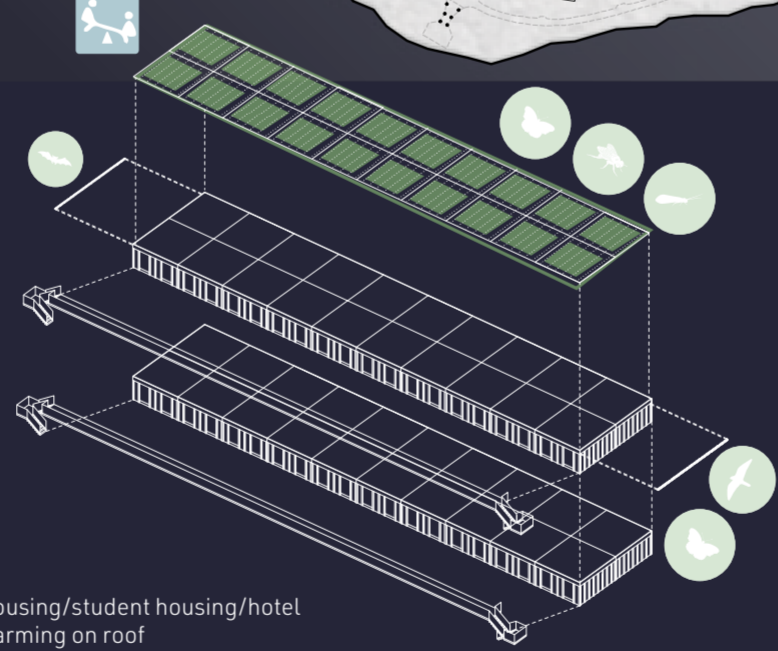

Youth housing/student housing/hotel
Urban farming on roof
Modular units

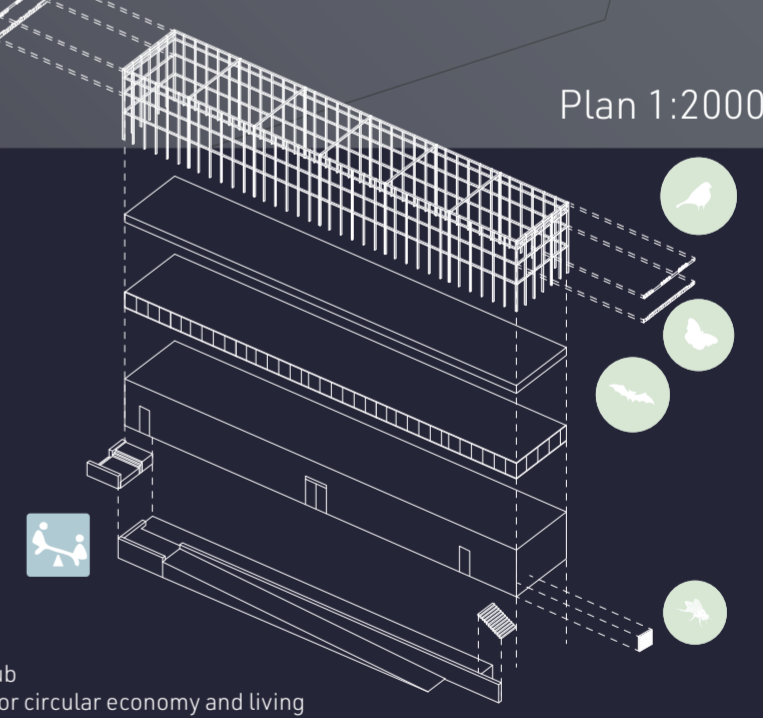

Circular economy hub
Information center for circular economy and living

Components biodiversity

Biodiversity in city environments is often scarce but can be supported with the right tools and environments. The proposal requires that new structures and buildings are made to support and enhance biodiversity instead of depleting it. They can be applied as add-ons to existing and new structures to become an integrated part of the building's envelope. The modular systems of the buildings make it possible for this new layer to be added to the structure.



Section 1:1000



HR767 VÄSTERÅS (SE) A (B) RIDGE BY THE WATER

3

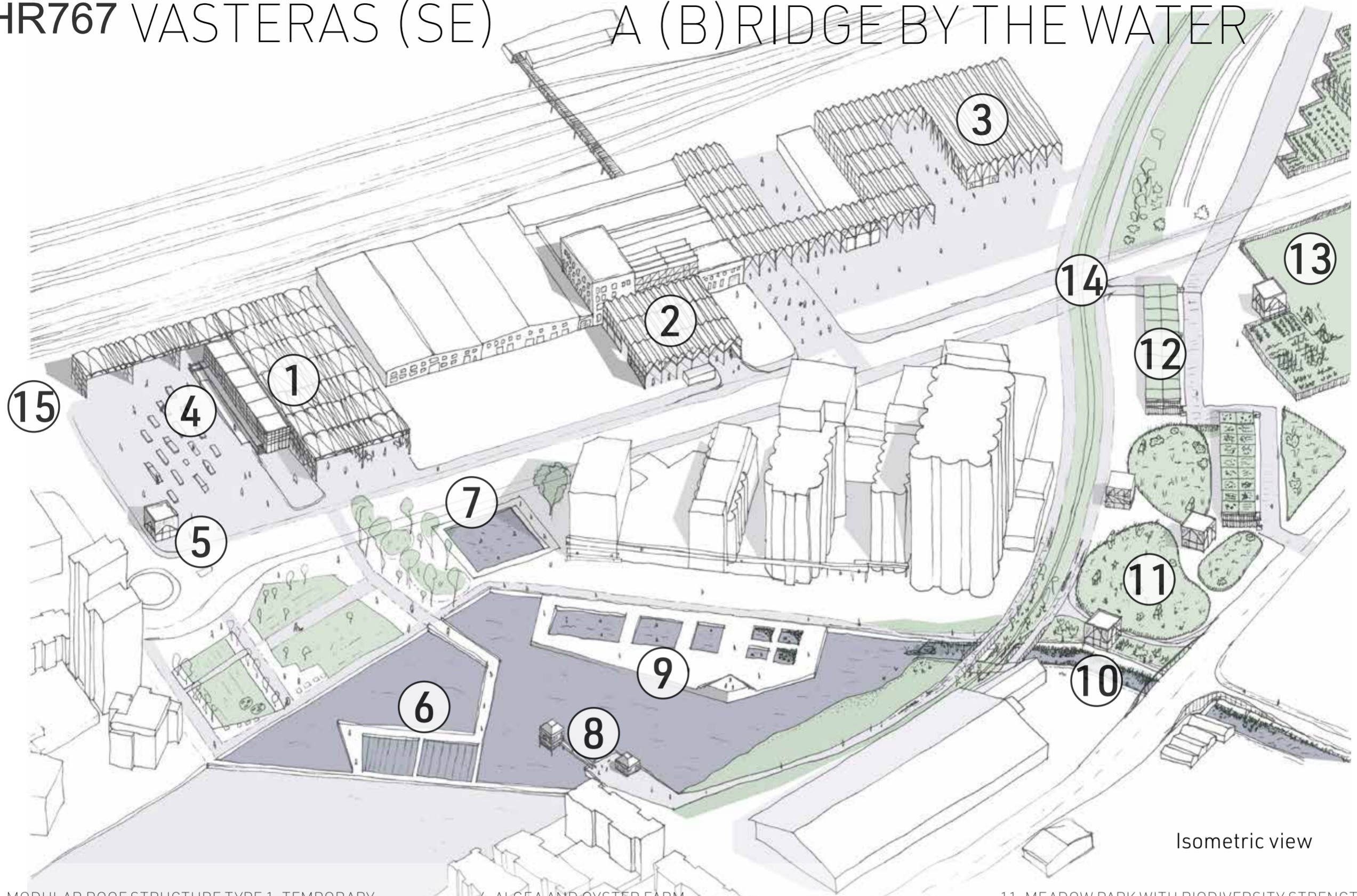

Isometric view

- 1. MODULAR ROOF STRUCTURE TYPE 1, TEMPORARY
- 2. MODULAR ROOF STRUCTURE TYPE 2, PARTLY TEMPORARY
- 3. OUTDOOR MARKET, PARTLY COVERED
- 4. PUBLIC SQUARE WITH CIRCULAR INFORMATION CENTRE
- 5. CIRCULAR INFORMATION AND TOOL HUB
- 6. ALGAE AND OYSTER FARM
- 7. OUTDOOR CHILDRENS BATH
- 8. PUBLIC SAUNA AND CHANGING AREA
- 9. PUBLIC OUTDOOR BATH WITH NATURAL CLEANING SYSTEM
- 10. NEW CANAL CONNECTING TO OTHER SIDE WITH CLEANING PLANTS
- 11. MEADOW PARK WITH BIODIVERSITY STRENGTHENING AND LOOK OUT TOWER
- 12. YOUTH/STUDENT HOUSING WITH FARMING ROOF
- 13. URBAN FARMING
- 14. VÄSTERÅS RAILWAY PARK
- 15. BASKETBALLCOURT AND OUTDOOR GYM/ACTIVITY AREA

Development and possible futures



Site today



- Step 1
 - Step 2
 - Step 3
- Timeline for the proposal in 3 steps.
- 1 - establishing parks, area and site during building of the new station
 - 2 - production sites
 - 3 - sites available after 2026

Proposal steps



After the new station has been built the roof structures have moved to alternative locations. The old silo can be repurposed and converted to unique living spaces or a hotel, in a similar way as the Steam Hotel. Other uses could be a modern art centre or centre for maker spaces. Parts of the silo is removed, and the Circular Information Centre is relocated. Part of the roof structure connects the two main silos and is made as a covered public space. Other parts of the roof a market hall for the urban farming. An alternative use is to cover the parts of the sewage plant.

Possible futures

